

Practical Exam Study Guide

WINDCHILL USER

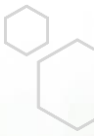
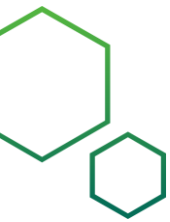

STUDY GUIDE SECTIONS

This study guide will help you prepare for your exam. It describes the skills and prerequisite coursework you need to succeed and provides sample questions. The study guide includes the following sections:

- FAQ
- Sample Questions





FAQ

What does it mean to be certified as a Windchill User?

A certified Windchill User has validated their fundamental knowledge and application of PTC University's LEARN Online curriculum.

Designers and engineers who are certified as a Windchill User can demonstrate fundamental knowledge of Windchill. They can navigate the user interface to create and manage work tasks that include using Creo View Lite, implementing the change process, and managing an engineering bill of materials (eBOM).



What can I expect when I take the practical exam?

Practical exams consist of a random set of questions based on use cases from PTC University courses. Project specifications and lab files provide the resources you need to correctly answer each question. You should plan to spend at least two hours on your exam, but you can take up to three hours to complete it. The exam will submit automatically after three hours, and the provided virtual machine (VM) will disconnect.

How are certifications used?

This digital credential gives your employers and peers concrete evidence of your capabilities. Once earned, digital credentials can be shared to your social media accounts, embedded in your online resume, or attached to your email signature.

FAQ

How long are certifications valid?

Certifications are valid for two years. You can retake the exam each year to stay up to date with the latest software knowledge.

What skills should I have before I take the Windchill User Exam?

- Search
- Information page
- Tables
- Documents
- Business objects
- Windchill parts
- Desktop integration
- Creo View Lite
- Product structure
- Baseline
- eBOM
- Part associations
- Filters
- Configuration specifications
- Reports
- Change management
- Change objects
- Requirements
- Roles
- Versioning

Which classes do you recommend I complete before taking the Windchill User Exam?

- Windchill: Fundamentals Overview
- Windchill: Fundamentals of Change Management
- Windchill: Fundamentals of Engineering Bill of Materials (eBOM)
- Windchill: Fundamentals of Creating and Managing Work

FAQ

How do I earn a certification?

Getting certified requires serious preparation. Learners who achieve a passing score have hands-on experience with the solution, complete all recommended courses, or do both. For those who complete the recommended courses, the most prepared learners take sufficient notes, participate in class discussions, and finish all course exercises.

The subject material covered by this exam can be found under the Windchill Training Catalog section.

The process looks like this:

- Take the recommended courses.
- Register for the exam.
- Review the course materials to prepare.
- Take the exam and earn a passing score of 80%.
- Check your email for a completion notification.
- Accept the digital credential on [Credly](#).

[ENROLL NOW](#)



SAMPLE QUESTIONS

The following questions are representative of what you will see in the practical exam. You cannot answer the sample questions because they depend on additional information provided in the VM. Sample questions are meant to show an example of what you will encounter and are not intended as a practice exam.

Sample Question 1

To answer this question, you must complete the following actions in the Windchill VM:

- Sign in to Windchill as **smiller/ptc**.
- *Caution: Do not save the credentials in your browser.*
- Go to the Home page.
- Open the Problem Report number **00003**.

In the Routing/Process History table, what is the listed status for the Problem Report Workflow?

- a. Checked Out
- b. In Work
- c. In Review
- d. Running
- e. Closed

SAMPLE QUESTIONS

Sample Question 2

To answer this question, you must complete the following actions in the Windchill VM:

- Sign in to Windchill as **achen/ptc**.
- *Caution: Do not save the credentials in your browser.*
- Navigate to the DRILL_900.ASM, A.1.
- Open it in Creo View.
- Select **DRILL_900.ASM, A.1** in the Model frame.
- Change the view to **Preset Explode**.

Which Preset Explode displays the model as shown?

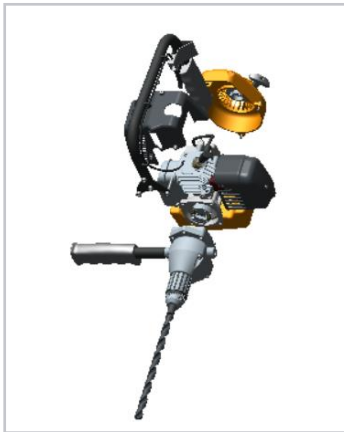

- DEFAULT
- EXP0001
- EXP0004
- EXP0006
- EXP0014